

AK-MINI



AMK PLASTICS LLC

7120 N.W. 51 STREET, MIAMI, FLORIDA 33166

TEL: 305-470-9088 FAX: 305-470-9091

Web: www.amk-plastics.com Email: amk@amk-plastics.com

AK-MINI

Machine Description

The Akei Mini 0.5L is one of our best selling machines. Priced economically, it is very fast in output, extremely compact in dimensions, and simple to service.

The standard machine has a scrap take-off conveyor, and finished bottles exit the sides on escape chutes. However, the Mini can be fully automated.

Sizes

Designed for mass production of small containers to 1mL minimum, the Mini can also produce bottles up to 16 oz. in size.

Head Combinations

Single, double, and triple heads are available to maximize output on each side.

Medical Parts

For medical parts, a 20 thickness parison programmer with special head is available. This is manufactured in the USA.

Speed

Dry cycle speed is 2.5 seconds. 7 to 8 seconds on a triple head cycle is normal, and a pharmaceutical bottle with 18 mm. neck in PE with excellent neck finish can be produced in up to 70,000 pieces/day.







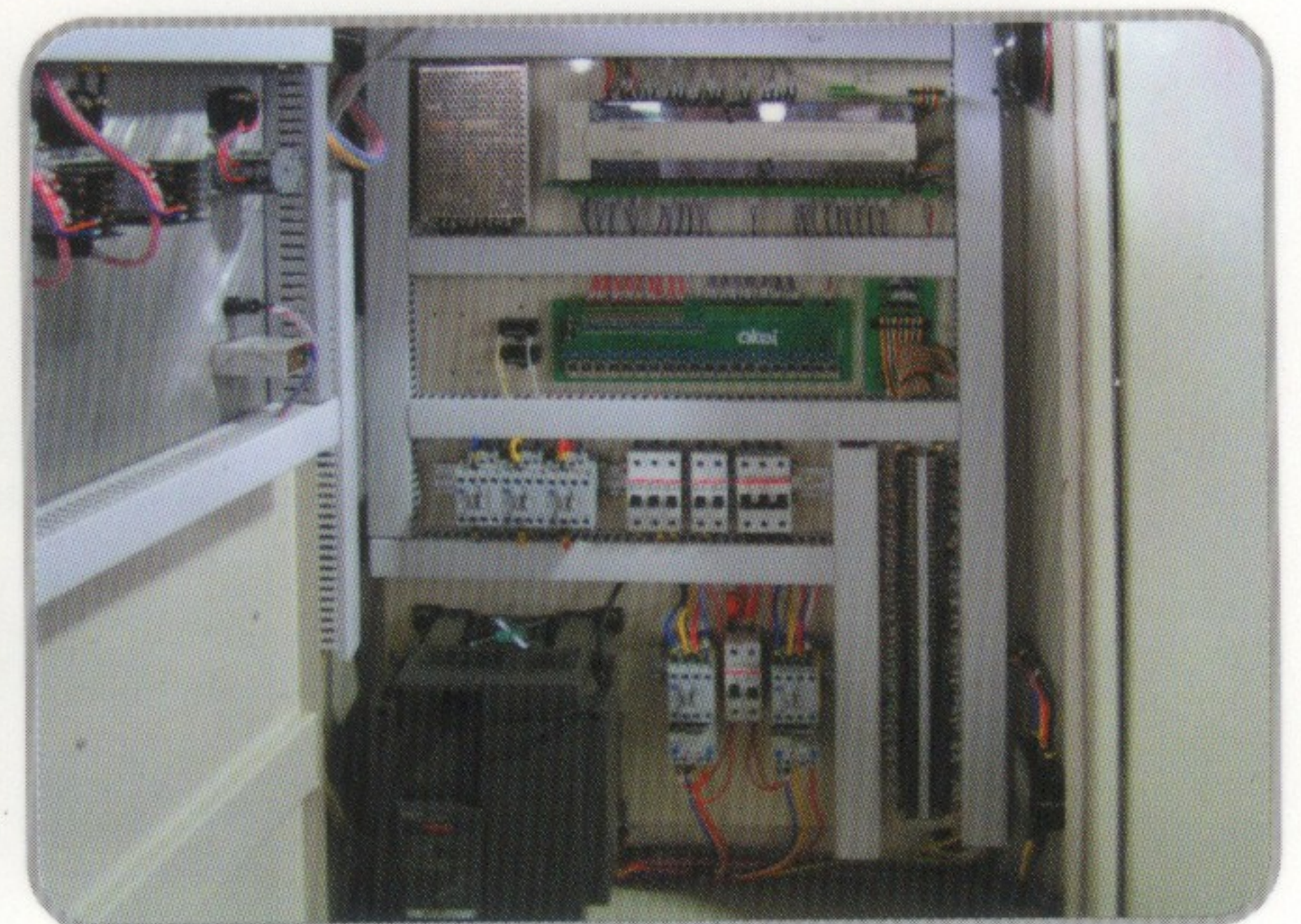
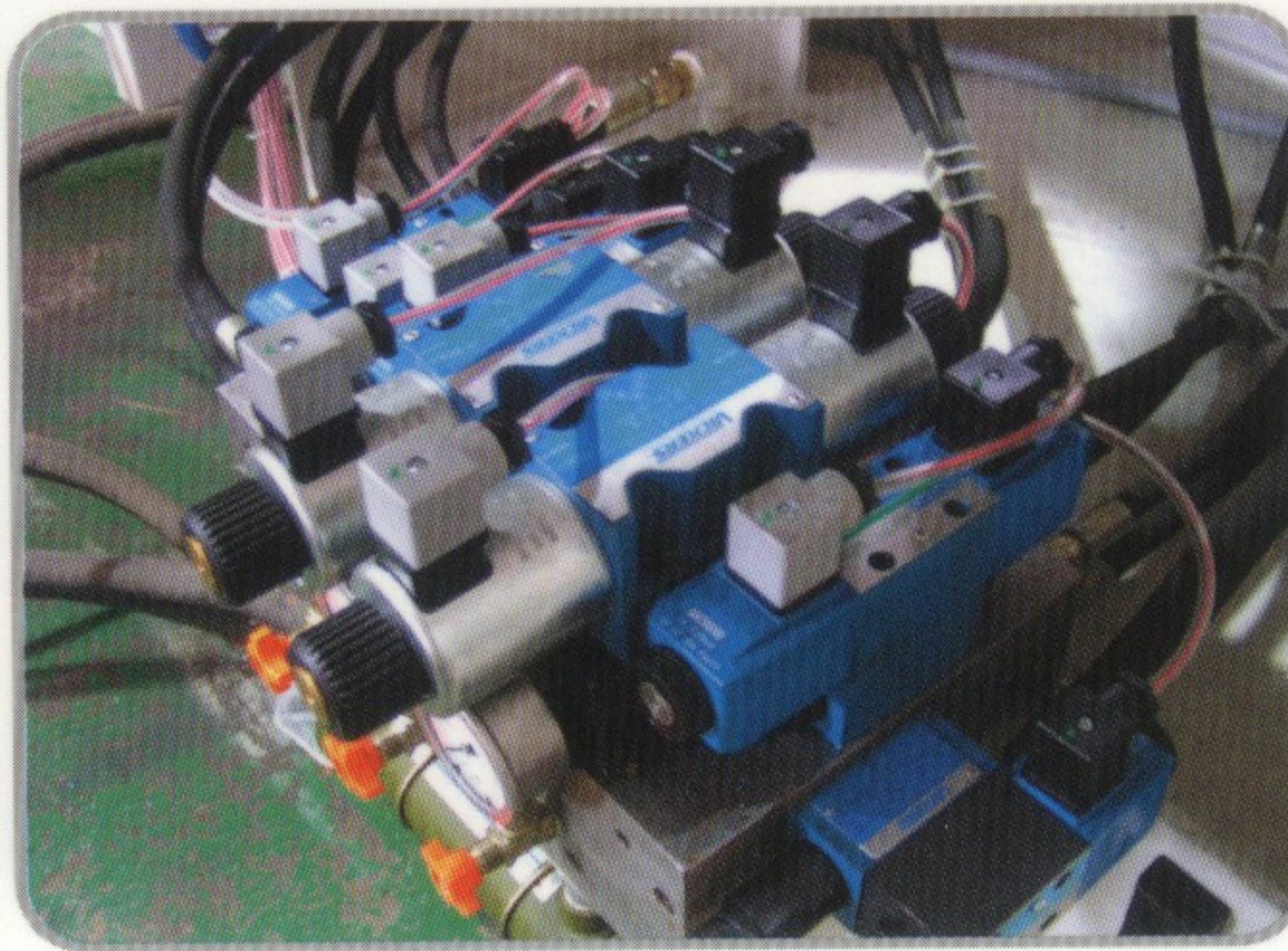
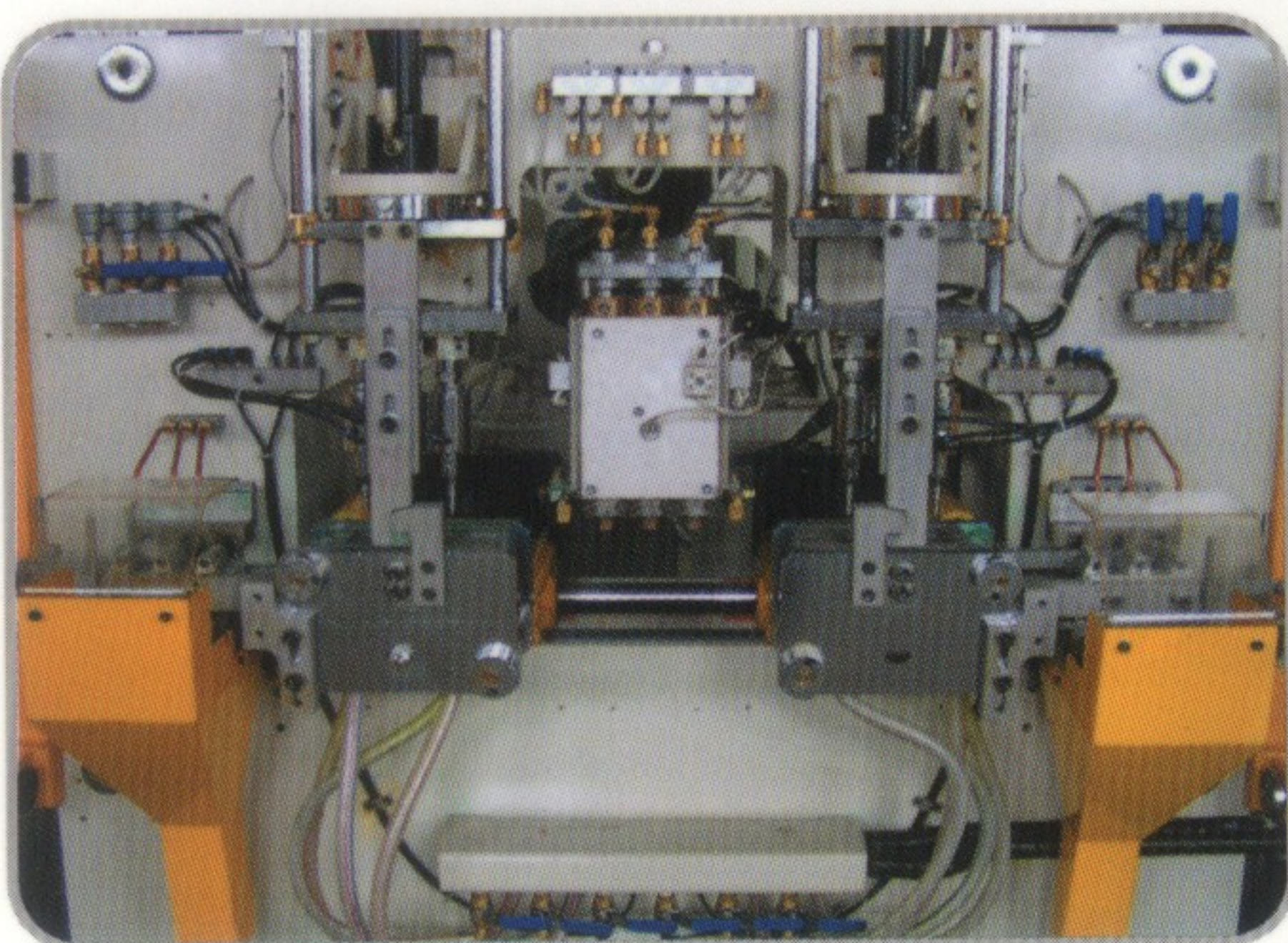

Materials

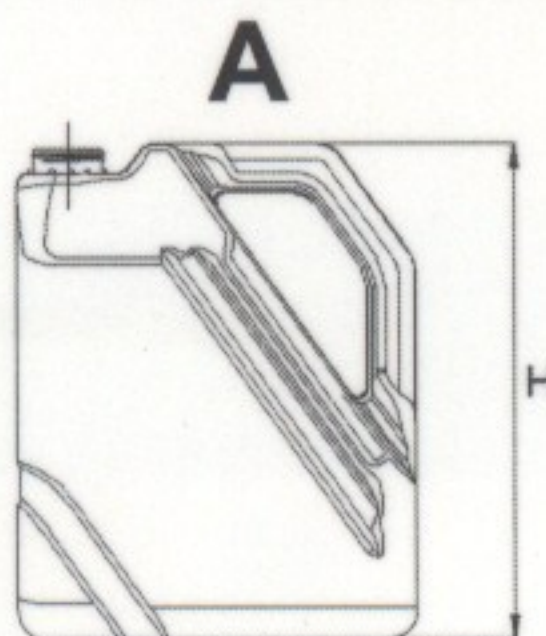
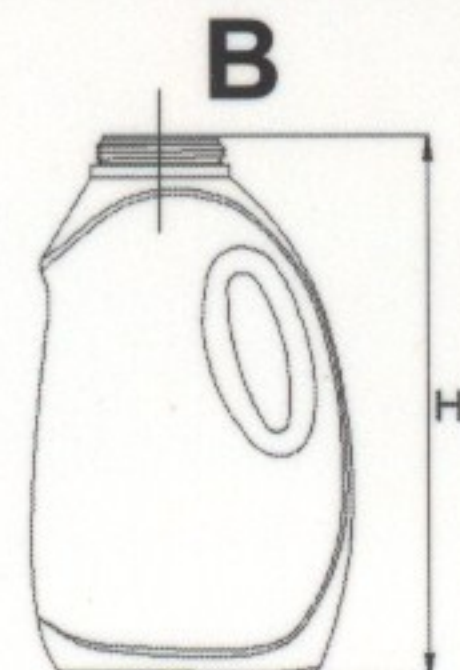
Besides PE, many containers run on the Mini in PP, PETG and PVC.

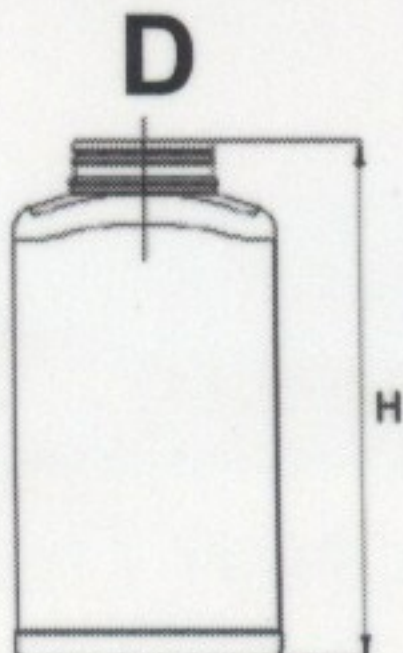
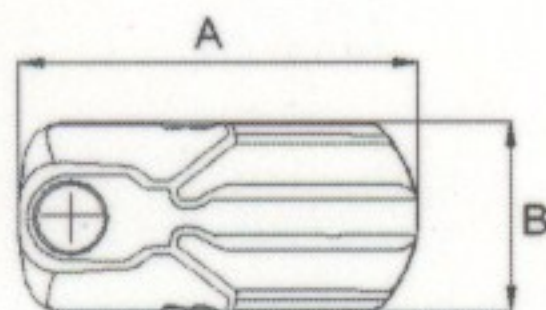
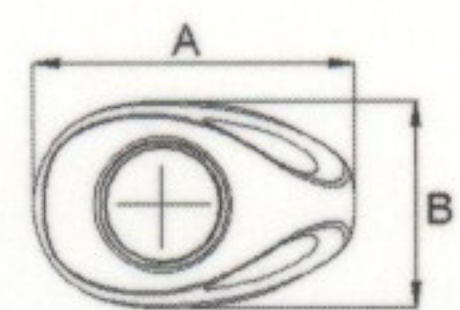
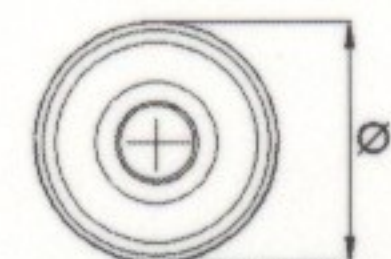
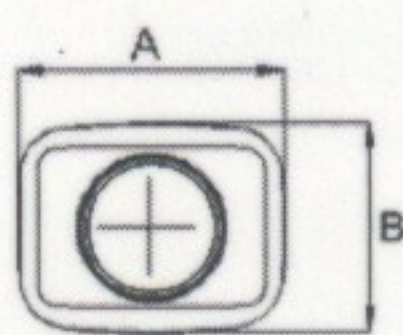
Power Saving Hit and Run Hydraulic Device

The Mini incorporates hydraulic pressure adjustable control device, using pressure only when needed. This reduces power consumption by up to 50%.



Bottle Dimensions									
									
									
Single Head Center Distance: ----									
									
A			B			C		D	
A	B	H	A	B	H	Ø	H	A	H
----	----	----	100	60	150	60	150	60	150
Double Head Center Distance: 70									
									
A			B			C		D	
A	B	H	A	B	H	Ø	H	A	H
----	----	----	60	60	150	60	150	55	150
Triple Head Center Distance: 45									
									
A			B			C		D	
A	B	H	A	B	H	Ø	H	A	H
----	----	----	35	60	150	35	150	33	150

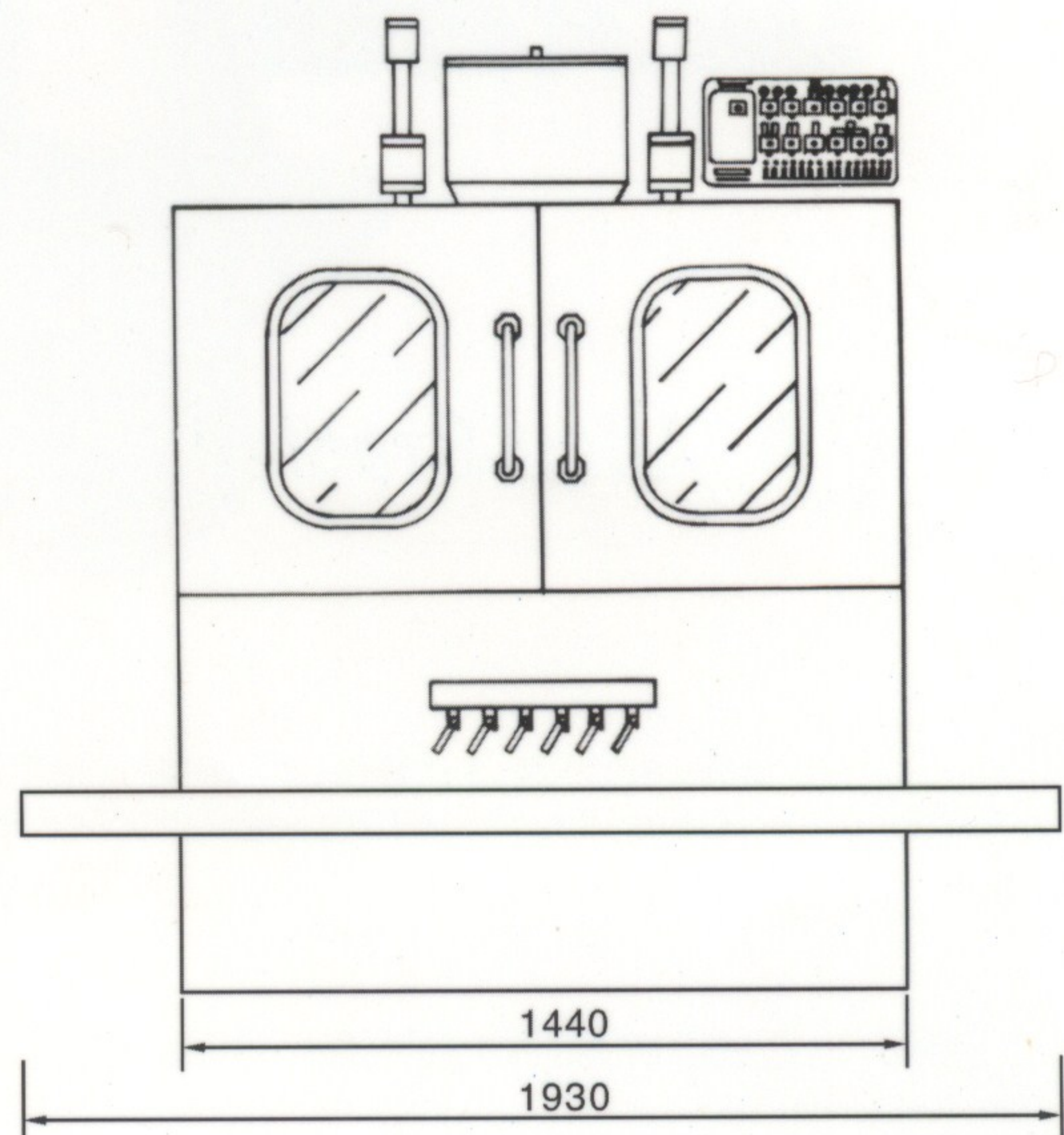
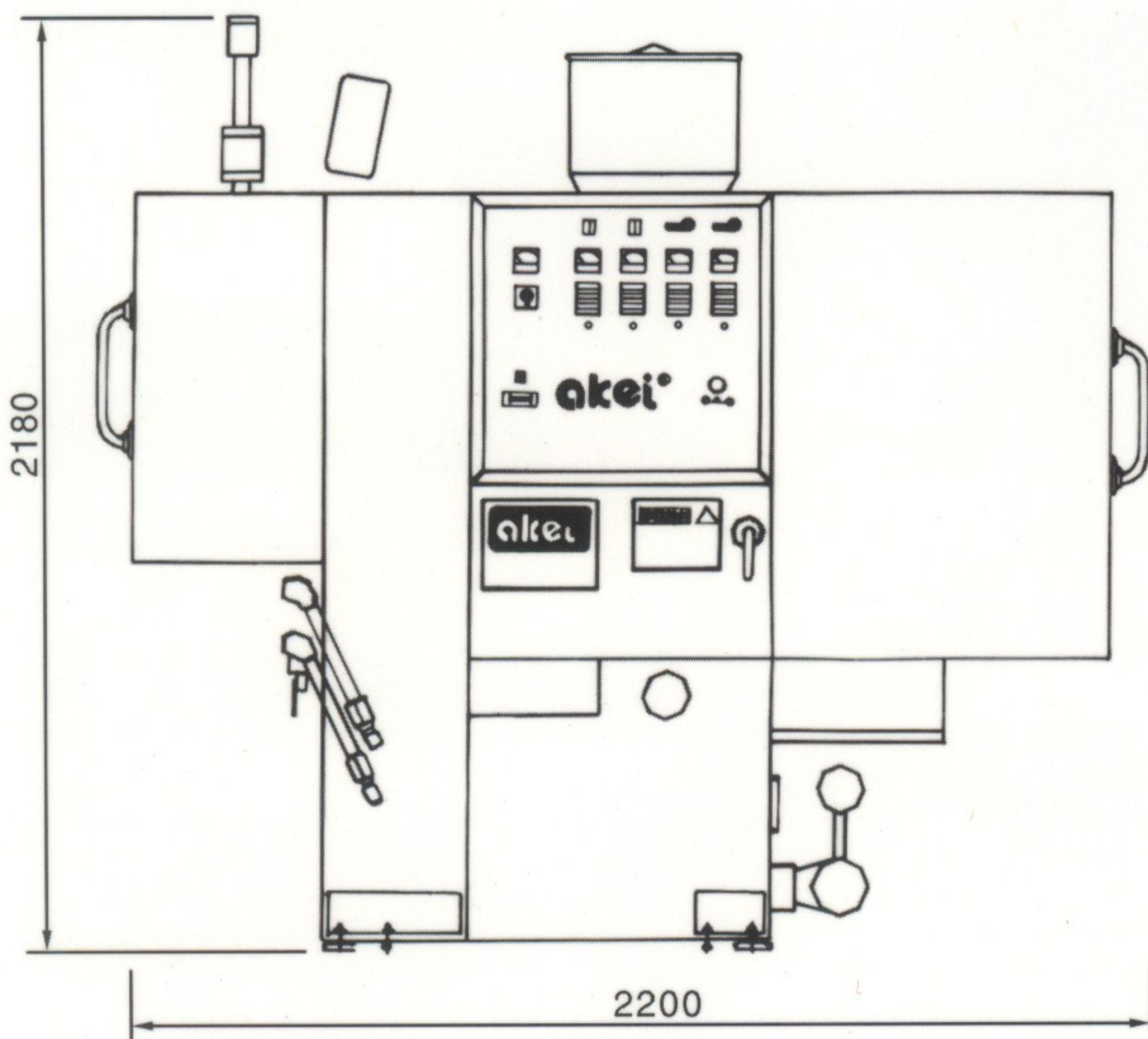
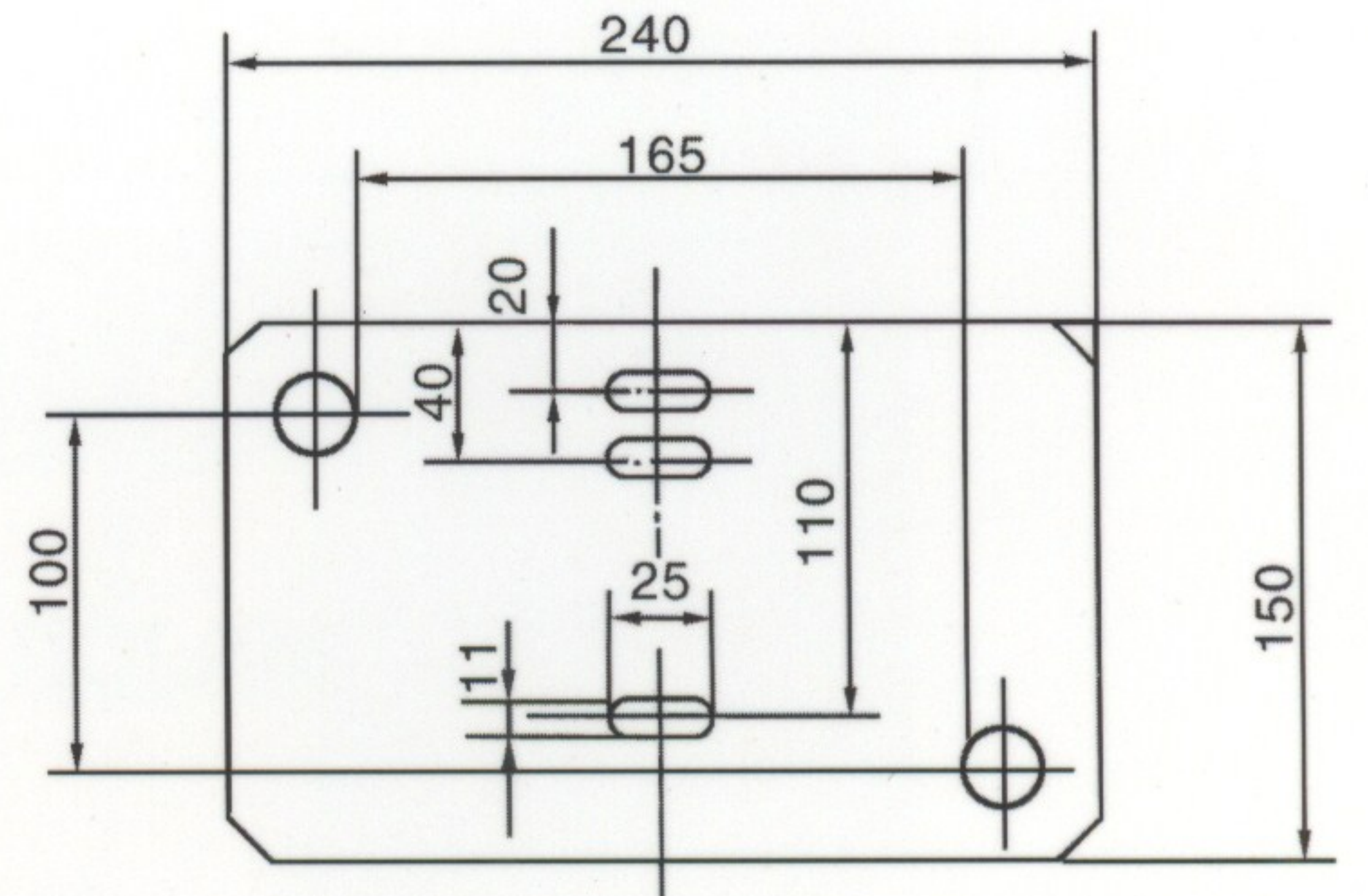
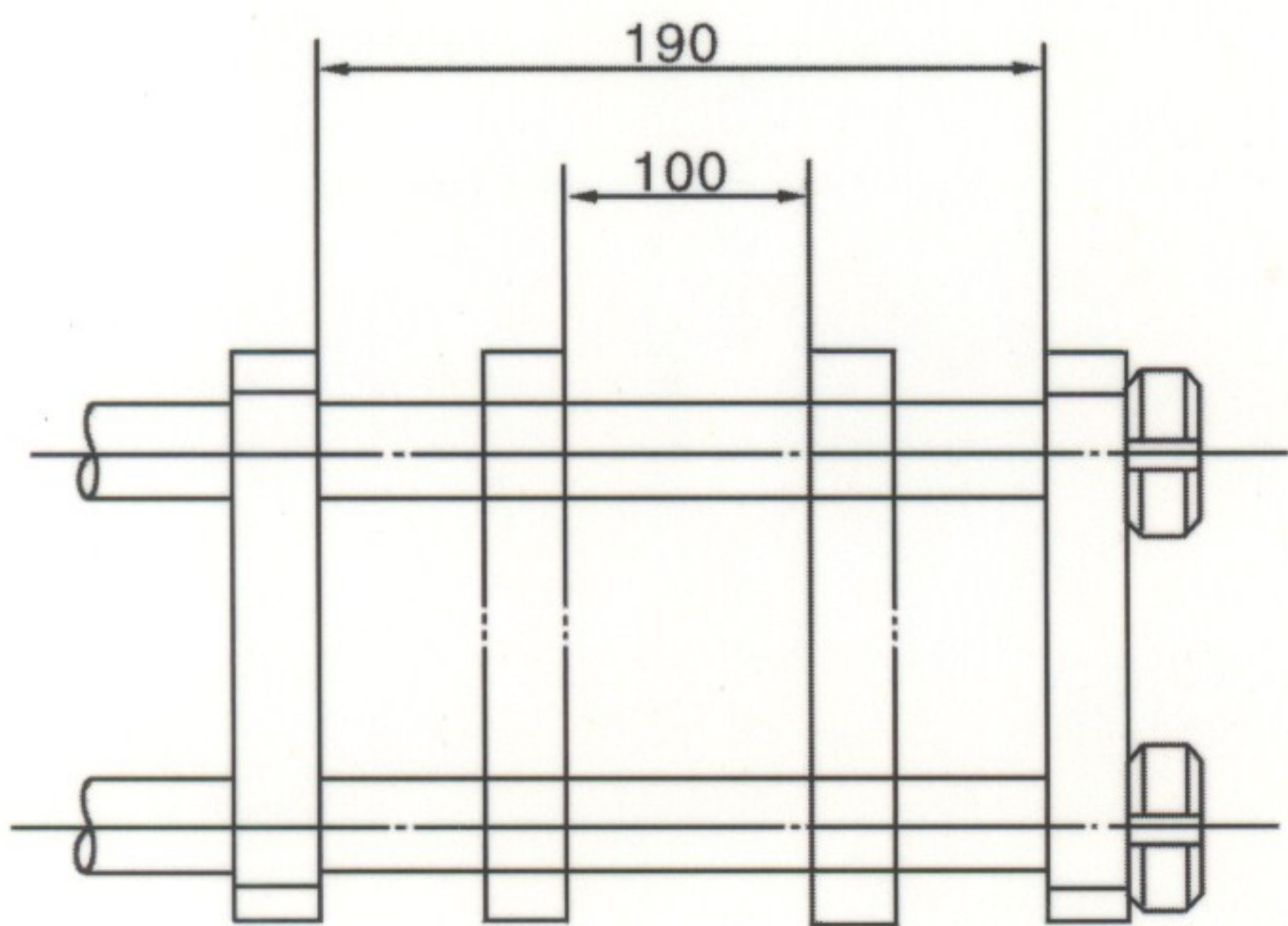

The above specifications are for reference only. We reserve rights for any modifications.

AK - Mini		
Specifications	Unit	Parameter
Screw Diameter	mm	40
Screw L / D	L / D	20:1
Extruding Speed	RPM	15~103
Extruding Volume (PE)	kg / h	20~22
Extruder Heating	Zones	2
Clamp Storke	mm	90
Clamp Force (160 BAR)	t	3
Dry Cycle	s	3
Water Consumption	m ³ / h	0.8
Air Consumption	m ³ / h	0.6
Net Weight (Approx.)	t	1
Power Consumption		kW
Invertor Drive Motor		5.5
Extruder Heater (PE)		3.6
Hydraulic Pump Motor		4
Die Heater		1.3~2.6
Max. Power Consumption		14.4~15.6

The above specifications are for reference only. We reserve rights for any modifications.

MAJOR COMPONENT SUPPLIERS

VICKERS

FESTO

MOOG



Allen-Bradley

